

DO NOT SCALE - IF IN DOUBT ASK

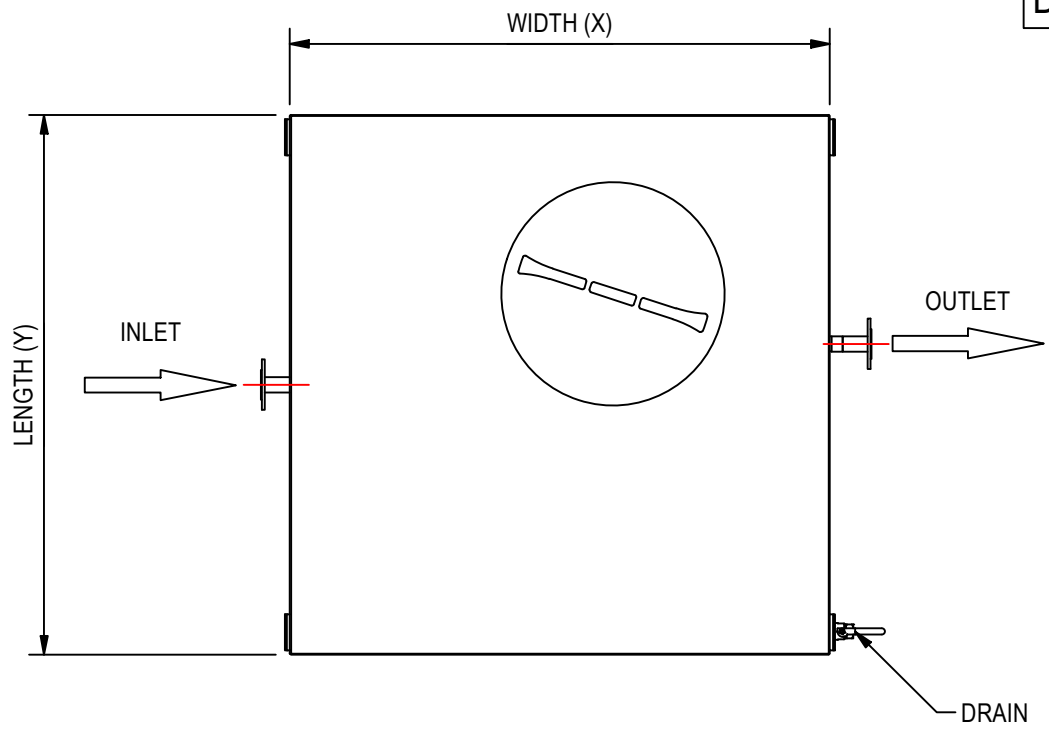

DIRECT TANKS - STD STAINLESS TANKS								
Nominal capacity size (L)	Material	Length (Y)	Width(X)	Height(Z)	Connections	Removeable lid	Small drain point with plug	Weight (kg)
80	SS304	500	400	400	x2 1" M	200mm insp/hatch	x1 1/2" F	60
180	SS304	600	500	600	x2 1" M	x1 400 Dia	x1 1/2" F	70
422	SS304	750	750	750	x2 1" M	x1 400 Dia	x1 1/2" F	100
563	SS304	1000	750	750	x2 1 1/2" M	x1 400 Dia	x1 1/2" F	110
312	SS304	1080	780	370	x2 1" M	x1 400 Dia	x1 1/2" F	90
1000	SS304	1000	1000	1000	x2 1 1/2" M	x1 400 Dia	x1 1" F	170
3375	SS304	1500	1500	1500	x2 1 1/2" M	x1 400 Dia	x1 1" F	340

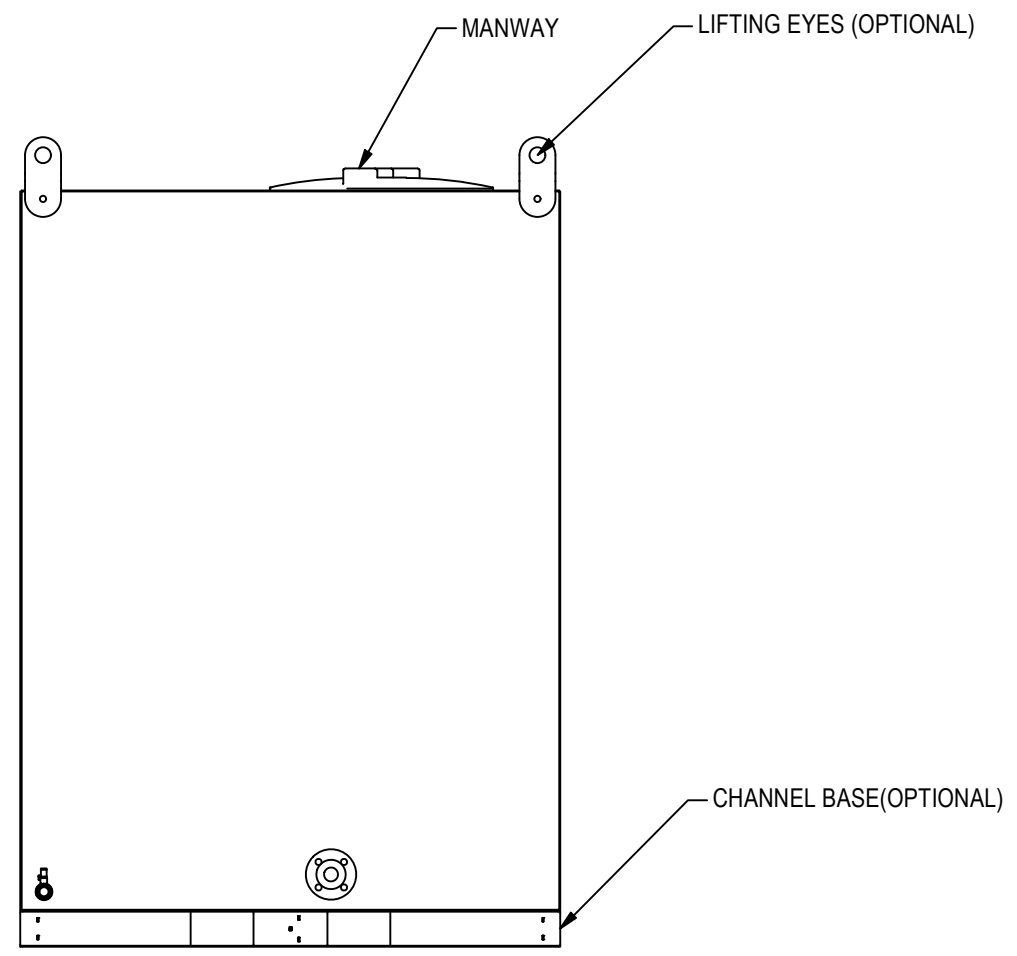
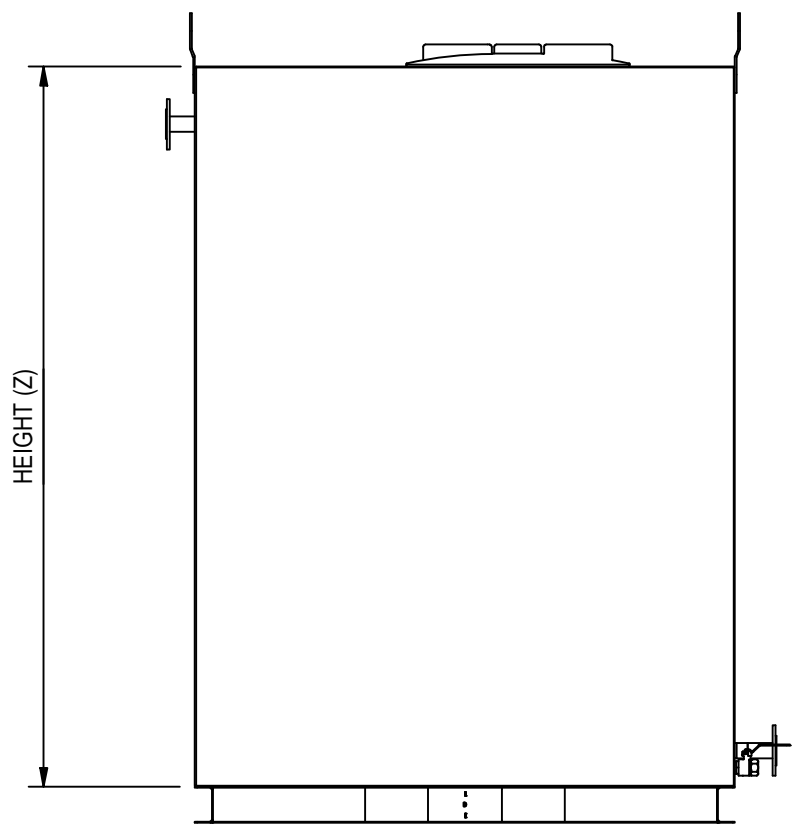

PROD APPD							THE COPYRIGHT OF THIS DOCUMENT IS OWNED BY DIRECT TANKS. IT IS ISSUED IN CONFIDENCE AND MUST NOT BE REPRODUCED IN ANY FORM, FOR ANY PURPOSE TO A THIRD PARTY EITHER WHOLLY OR IN PART WITHOUT WRITTEN CONSENT.		TITLE DIRECT TANKS - STAINLESS STEEL TANKS				
DES APPD							ALL DIMENSIONS IN MM EXPLANATION OF DIMENSIONS ETC. SEE BS 8888	CLIENT	DESCRIPTION TANKS (VARIOUS SIZES)				
CHECKED	A	ISSUED FOR APPROVAL	12.04.24	TRG	RS		THIRD ANGLE PROJECTION	PROJECT	DRAWING No. SK161-GA-01	REV A	SCALE 1:21	SHT No. 1 of 7	SIZE A3
ISS		DESCRIPTION	DATE	DRN	APPD								