

Inlet Orientation
(Duct positioned @ 180°)

Notes:

- Pumpwell delivered with pumps & floats not installed to avoid damage in transit.
- Pumps to be coupled to chains with shackles supplied in lifting chain which is connected to the unistrut assembly.
- Read operating and installation guidelines before installing.

Case Diameter	Outlet Invert 'C'	Case Depth 'B'		Inlet Invert 'A' - Standard		Inlet Size 'E'
		20 (2.0m)	25 (2.5m)	10 (1.0m)	15 (1.5m)	
10 (1.0m)	0.6m	•		•		110mm
			•		•	160mm

Please check with Kingspan Water & Energy for the latest Issue of the drawing

Issue	Date	Drawn By	Approved By	Description
03	16/12/2022	TGY		ECN 1641 - Access Size Added
02	29/05/2018	WMD		CC1434 - HLA/Assist float position changed

LN Number :
Finish :
Weight :
Modelled By : Author

Tolerance (unless stated) :
Thickness :
Surface Area : m²
Material : PE

Drawing : DS1060P

Page 1 of 1

All Dimensions In mm Scale: Do Not Scale

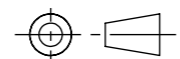

Third Angle Projection

Kingspan Water & Energy reserve the right to alter the details of this drawing without prior notice. This drawing is copyright and may not be reproduced or used without the written permission of Kingspan Water & Energy

