

REFER TO SHEET 2 FOR DIMENSIONS 'A', 'B', 'C' and 'E'

Notes:

- Pumpwell delivered with pumps & Floats not installed to avoid damage in transit.
- Pumps to be coupled to chains with shackles supplied on lifting chain which is connected to the unistrut assembly.
- Read Operating and Installation guideleines before installing.

Please check with Kingspan Water & Energy for the latest Issue of the drawing

Issue	Date	Drawn By	Approved By	Description
04	16/12/2022	TGY		ECN 1641 - Access Size Added
03	06/03/2018	WMD		CC1421 - Pump Chamber Depths added

LN Number :	Tolerance (unless stated) : +/-10 mm
Finish : n/a	Thickness : n/a
Weight : n/a	Surface Area : n/a m ²
Modelled By :	Material : Various

Drawing : DS1057P Page 1 of 2
Ø1.2m Single Sewage Pump Chamber

All Dimensions In mm Scale: Do Not Scale

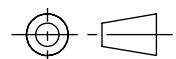

Third Angle Projection

Kingspan Water & Energy reserve the right to alter the details of this drawing without prior notice. This drawing is copyright and may not be reproduced or used without the written permission of Kingspan Water & Energy



STANDARD INVERTS

Case Diameter	Outlet Invert 'C'	Case Depth 'B'					Inlet Invert 'A' - Standard					Inlet Size 'E'
		20 (2.0m)	25 (2.5m)	30 (3.0m)	35 (3.5m)	40 (4.0m)	10 (1.0m)	15 (1.5m)	20 (2.0m)	25 (2.5m)	30 (3.0m)	
12 (1.3m)	0.7m	•					•					110mm 160mm
			•				•	•				
				•			•	•	•			
					•		•	•	•	•		
						•	•	•	•	•	•	

ALTERNATE STANDARD INVERTS

Case Diameter	Outlet Invert 'C'	Case Depth 'B'					Inlet Invert 'A' - Alternate Standard Inverts																	Inlet Size 'E'					
		20 (2.0m)	25 (2.5m)	30 (3.0m)	35 (3.5m)	40 (4.0m)	09 (0.9m)	11 (1.1m)	12 (1.2m)	13 (1.3m)	14 (1.4m)	16 (1.6m)	17 (1.7m)	18 (1.8m)	19 (1.9m)	21 (2.1m)	22 (2.2m)	23 (2.3m)	24 (2.4m)	26 (2.6m)	27 (2.7m)	28 (2.8m)	29 (2.8m)		31 (2.8m)	32 (2.8m)	33 (2.8m)		
12 (1.3m)	0.7m	•					•	•	•	•																			110mm 160mm
			•				•	•	•	•	•	•	•	•															
				•			•	•	•	•	•	•	•	•	•	•	•	•	•										
					•		•	•	•	•	•	•	•	•	•	•	•	•	•	•	•	•	•						
						•	•	•	•	•	•	•	•	•	•	•	•	•	•	•	•	•	•	•	•	•	•	•	

LN Number :	Tolerance (unless stated) :	Drawing : DS1057P	Page 2 of 2
Finish :	Thickness :		
Weight :	Surface Area : m ²	Ø1.2m Single Sewage Pump Chamber	
Modelled By :	Material :		

All Dimensions In mm Scale: Do Not Scale

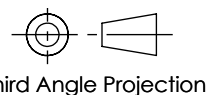

Kingspan Water & Energy reserve the right to alter the details of this drawing without prior notice. This drawing is copyright and may not be reproduced or used without the written permission of Kingspan Water & Energy

